

## Antirretornos

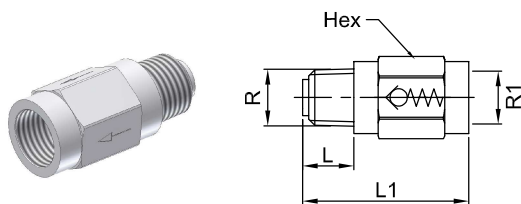

Referencia	R	R1	L	L1	Hex.
508010000	M8x1	M8x1 DIN2367	7,5	21.5	11
508020000	G 1/8	G 1/8	11,5	34	12

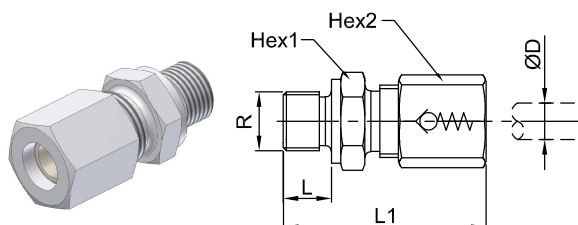

Referencia	R	ØD	L	L1	Hex1	Hex2
508030000	G 1/8	Ø8 LL	11,5	30	14	14
508030010	M10x1	Ø8 LL	11,5	30	14	14
508040000	G 1/8	Ø6 L	11,5	30	14	14
508050000	G 1/8	Ø8 L	11,5	30	14	17
508035000	G 1/4	Ø6 L	15,5	36	19	14
508045000	G 1/4	Ø8 L	15,5	36	19	17

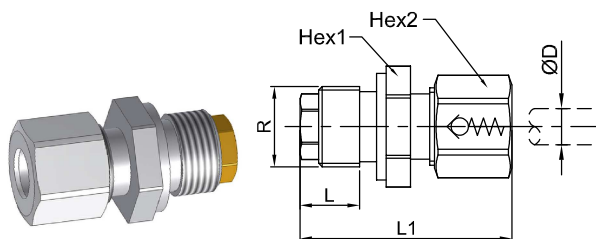

Referencia	R	ØD	L	L1	Hex1	Hex2
508055000	G 3/8	Ø8 L	16	40	22	17
508070000	G 3/8	Ø10 L	16	40	22	19
508060000	G 3/8	Ø8 S				

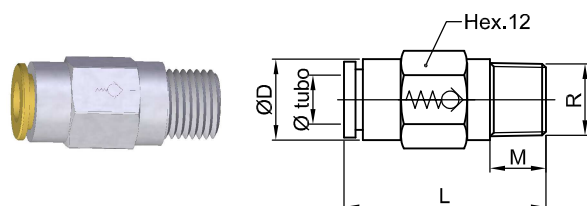

Referencia	R	ØTubo	M	L	ØD	Apertura
508090000	M10x1	6	6	30	12	3 bar

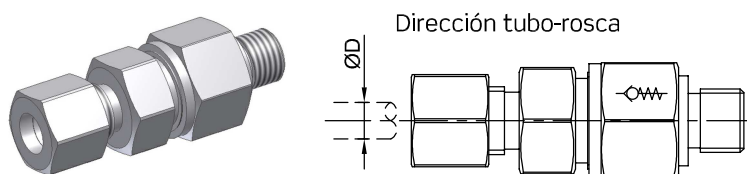

Referencia	R	ØD	Apertura
508110000	G 1/8	Ø6 L	10 bar
508115000	G 1/8	Ø6 L	20 bar
508140000	G 1/4	Ø8 L	10 bar
508145000	G 1/4	Ø8 L	20 bar
508170000	G 1/4	Ø10 L	10 bar
508175000	G 1/4	Ø10 L	20 bar

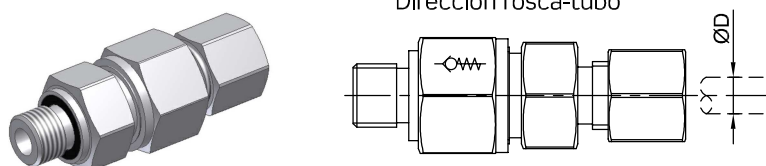

Referencia	R	ØD	Apertura
508210000	G 1/8	Ø6 L	10 bar
508215000	G 1/8	Ø6 L	20 bar
508240000	G 1/4	Ø8 L	10 bar
508245000	G 1/4	Ø8 L	20 bar
508270000	G 1/4	Ø10 L	10 bar
508275000	G 1/4	Ø10 L	20 bar



Referencia	ØD	ØD1	Apertura
508310000	Ø6 L	Ø6 L	10 bar
508315000	Ø6 L	Ø6 L	20 bar
508340000	Ø8 L	Ø8 L	10 bar
508345000	Ø8 L	Ø8 L	20 bar
508370000	Ø10 L	Ø10 L	10 bar
508375000	Ø10 L	Ø10 L	20 bar

## Antirretornos

### Tubo-rosca

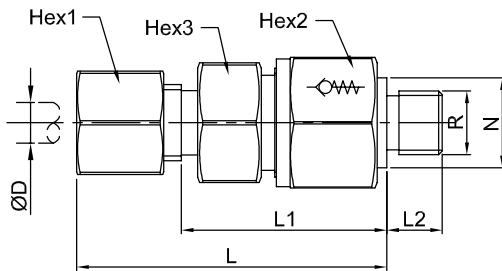

Presión de apertura: 1 bar  
Rosca BSP

### Rosca-tubo

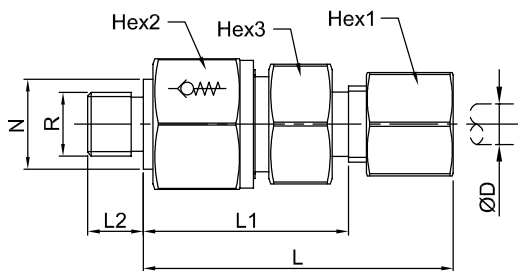

Presión de apertura: 1 bar  
Rosca BSP

### Tubo-Tubo

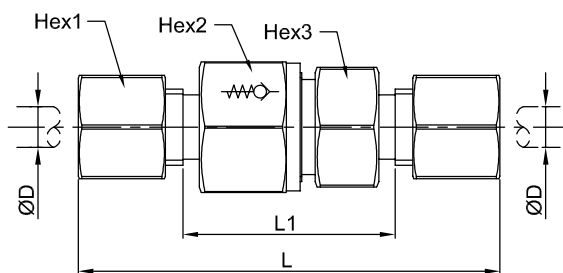

Presión de apertura: 1 bar

Referencia	ØD	PN	R	N	L	L1	L2	Hex1	Hex2	Hex3
952301001	Ø6 L	250	1/8	14	41	26,5	8	14	17	17
952301002	Ø8 L	250	1/4	19	43	28,5	12	17	19	19
952301003	Ø10 L	250	1/4	19	53	38,5	12	19	24	22
952301004	Ø12 L	250	3/8	22	55	40,5	12	22	30	27
952301005	Ø15 L	250	1/2	27	57,5	42,5	14	27	32	27
952301006	Ø18 L	160	1/2	27	64	48	14	32	36	36
952301007	Ø22 L	160	3/4	32	72	56	16	36	46	41
952301008	Ø28 L	100	1	40	80,5	64	18	41	55	50
952301009	Ø35 L	100	1 1/4	50	91,5	70	20	50	60	60
952301010	Ø42 L	100	1 1/2	55	93	70,5	22	60	70	65
952301011	Ø6 S	400	1/4	19	46	31,5	12	17	19	19
952301012	Ø8 S	400	1/4	19	46	31,5	12	19	19	19
952301013	Ø10 S	400	3/8	22	54	38	12	22	24	22
952301014	Ø12 S	400	3/8	22	57	41	12	24	27	24
952301015	Ø14 S	400	1/2	27	61	43,5	14	27	32	27
952301016	Ø16 S	400	1/2	27	64	46	14	30	36	32
952301017	Ø20 S	400	3/4	32	71,5	50	16	36	46	41
952301018	Ø25 S	250	1	40	78,5	54,5	18	46	50	46
952301019	Ø30 S	250	1 1/4	50	90,5	64	20	50	60	60
952301020	Ø38 S	250	1 1/2	55	102	74,5	22	60	70	65

Referencia	ØD	PN	R	N	L	L1	L2	Hex1	Hex2	Hex3
952302001	Ø6 L	250	1/8	14	42,5	28	8	14	17	17
952302002	Ø8 L	250	1/4	19	44,5	30	12	17	19	19
952302003	Ø10 L	250	1/4	19	53	38,5	12	19	24	22
952302004	Ø12 L	250	3/8	22	57	42,5	12	22	30	27
952302005	Ø15 L	250	1/2	27	60,5	45,5	14	27	32	27
952302006	Ø18 L	160	1/2	27	66	50	14	32	36	36
952302007	Ø22 L	160	3/4	32	71	55	16	36	46	41
952302008	Ø28 L	100	1	40	79,5	63	18	41	55	50
952302009	Ø35 L	100	1 1/4	50	90,5	69	20	50	60	60
952302010	Ø42 L	100	1 1/2	55	91	68,5	22	60	70	65
952302011	Ø6 S	400	1/4	19	46	31,5	12	17	19	19
952302012	Ø8 S	400	1/4	19	46	31,5	12	19	19	19
952302013	Ø10 S	400	3/8	22	54	38	12	22	24	22
952302014	Ø12 S	400	3/8	22	57	41	12	24	27	24
952302015	Ø14 S	400	1/2	27	62	44,5	14	27	32	27
952302016	Ø16 S	400	1/2	27	66	48	14	30	36	32
952302017	Ø20 S	400	3/4	32	73,5	52	16	36	46	41
952302018	Ø25 S	250	1	40	78,5	54,5	18	46	50	46
952302019	Ø30 S	250	1 1/4	50	90,5	64	20	50	60	60
952302020	Ø38 S	250	1 1/2	55	100	69,5	22	60	70	65

Referencia	ØD	PN	L	L1	Hex1	Hex2	Hex3
952300001	Ø6 L	250	58	29	14	17	17
952300002	Ø8 L	250	59	30	17	19	19
952300003	Ø10 L	250	69,5	40,5	19	24	22
952300004	Ø12 L	250	72,5	43,5	22	30	27
952300005	Ø15 L	250	77,5	47,5	27	32	27
952300006	Ø18 L	160	83,5	51,5	32	36	36
952300007	Ø22 L	160	93,5	61,5	36	46	41
952300008	Ø28 L	100	102,5	69,5	41	55	50
952300009	Ø35 L	100	117,5	74,5	50	60	60
952300010	Ø42 L	100	119	74	60	70	65
952300011	Ø6 S	400	63,5	34,5	17	19	19
952300012	Ø8 S	400	63,5	34,5	19	19	19
952300013	Ø10 S	400	72,5	40,5	22	24	22
952300014	Ø12 S	400	74,5	42,5	24	27	24
952300015	Ø14 S	400	82,5	47,5	27	32	27
952300016	Ø16 S	400	86,5	50,5	30	36	32
952300017	Ø20 S	400	97,5	54,5	36	46	41
952300018	Ø25 S	250	106,5	58,5	46	50	46
952300019	Ø30 S	250	122,5	69,5	50	60	60
952300020	Ø38 S	250	136,5	75,5	60	70	65